

GENERAL NOTES

ANY DISCREPANCIES OR OMISSIONS TO BE REPORTED TO JAK CONSULTING ENGINEERS IMMEDIATELY.

DO NOT SCALE - WORK FROM FIGURED DIMENSIONS ONLY.

THIS DRAWING IS TO BE READ IN CONJUNCTION WITH ALL CIVIL ENGINEERS, STRUCTURAL ENGINEERS, ARCHITECTS & ALL OTHER RELEVANT DRAWINGS & SPECIFICATIONS RELATING TO THE PROJECT.

ALL DIMENSIONS TO BE CONFIRMED ON SITE.

THIS DRAWING IS THE PROPERTY OF JAK CONSULTING ENGINEERS AND IT OR ITS CONTENTS CANNOT BE COPIED, REPRODUCED OR OTHERWISE USED WITHOUT THE PERMISSION & CONSENT OF JAK CONSULTING ENGINEERS.

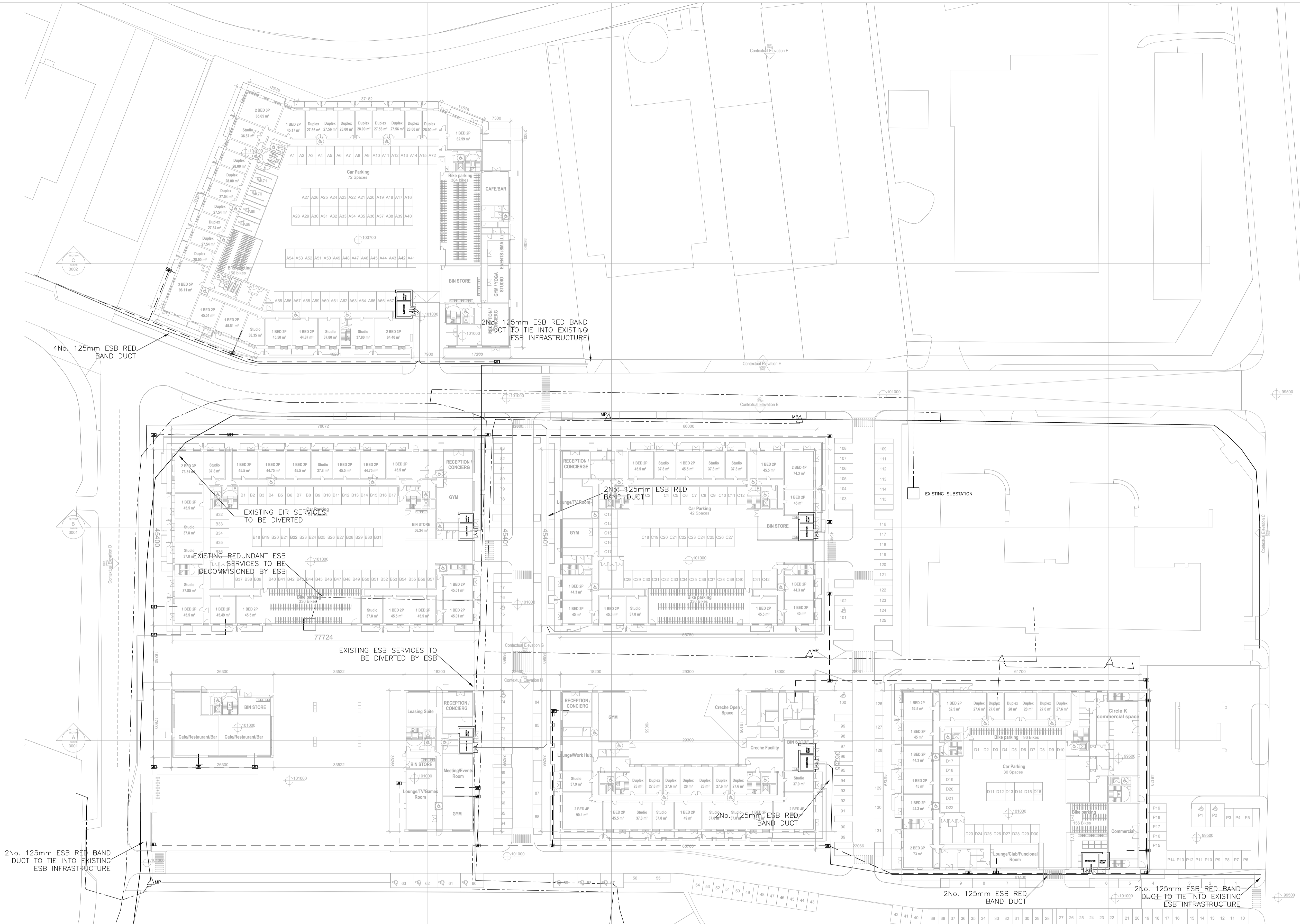

- LEGEND**
- PROPOSED ESB M/LV DUCT ROUTE.
 - - - EXISTING ESB SERVICE DUCT (APPROXIMATE LOCATION)
 - - - EXISTING EIR SERVICE DUCT (APPROXIMATE LOCATION)
 - - - PROPOSED ROUTE OF 2 NO. 100mm COMMS DUCT FOR PROVISION OF TELEPHONY & COMMS
 - ⊠ PROVIDER APPROVED JUNCTION BOX JB4 FOR COMMS SERVICES

NOTE:
 THE BUILDING IS DESIGNED IN SUCH A WAY SO THE CENTRAL CORE RISERS ARE ALL COLLECTABLE & LINK SO TO ALLOW FOR FUTURE CENTRALIZATION OF SERVICES WHICH WOULD ALLOW FOR EASE OF CONNECTION TO FUTURE CENTRALIZED HEATING SYSTEM. REFER TO DRAWING JS216-303 FOR THE PLANT LOCATION SERVING THE BLOCKS.

1 2	PLANNING ISSUE	NM	MO	25/11/2020
1 1	ISSUED FOR INFORMATION	NM	JK	20-12-19
REV	Description	DRN	APP	Date

JAK Consulting Engineers

Mechanical, Electrical & Sustainability
 Design
 12 Camden Row, Dublin 8, Ireland
 Ph: +353(1)479 0500
 E: info@jak.ie
 www.jak.ie

PROJECT CLIENT:
 COOKSTOWN CASTLE
 COOKSTOWN INDUSTRIAL ESTATE
 JOSEPH COSTELLO, ABSOLUTE LIMOUSINES LTD
 BOHERKILL PROPERTY DEVELOPMENT LTD

ARCHITECT:
 CWO ARCHITECTS

DRAWING TITLE:
 ESB & EIR SITE INFRASTRUCTURE
 ESB & SWITCHROOM ALLOWANCE
 GROUND FLOOR LAYOUT

DRAWING REFERENCE: J5906-102
DRAWING/PROJECT STATUS: INFORMATION
REVISION REF: 1 2

FILENAME: J5906-102.dwg
DATE: 12/12/19
DRAWN: NM
SCALE @ A1: 1/500